



**CHENMKO ENTERPRISE CO.,LTD**

*Halogens free devices*

**SURFACE MOUNT**

**SCHOTTKY BARRIER DIODE**

**VOLTAGE 40 Volts CURRENT 0.2 Ampere**

**CH521S-40GP**

**APPLICATION**

\* Low power rectification and high speed switching

**FEATURE**

\* Extremely small surface mounting type. (SC-79/SOD-523)  
 \* High reliability  
 \* Lead free devices

**CONSTRUCTION**

\* Silicon epitaxial planar

**MARKING**

\* S



**SC-79/SOD-523**

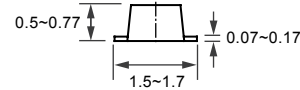

Dimensions in millimeters

**SC-79/SOD-523**

**CIRCUIT**



**MAXIMUM RATINGS** ( At  $T_A = 25^\circ\text{C}$  unless otherwise noted )

RATINGS	SYMBOL	CH521S-40GP	UNITS
Maximum Recurrent Peak Reverse Voltage	VRRM	45	Volts
Maximum RMS Voltage	VRMS	28	Volts
Maximum DC Blocking Voltage	VDC	40	Volts
Maximum Average Forward Rectified Current	IO	0.2	Amps
Peak Forward Surge Current at 8.3 mSec single half sine-wave	IFSM	4.0	Amps
Typical Junction Capacitance between Terminal (Note 1)	CJ	27	pF
Maximum Operating Temperature Range	TJ	+125	$^\circ\text{C}$
Storage Temperature Range	TSTG	-40 to +125	$^\circ\text{C}$

**ELECTRICAL CHARACTERISTICS** ( At  $T_A = 25^\circ\text{C}$  unless otherwise noted )

CHARACTERISTICS	SYMBOL	CH521S-40GP	UNITS
Maximum Instantaneous Forward Voltage at $I_F = 10\text{mA}$	V <sub>F</sub>	0.30	Volts
Maximum Instantaneous Forward Voltage at $I_F = 100\text{mA}$	V <sub>F</sub>	0.45	Volts
Maximum Instantaneous Forward Voltage at $I_F = 200\text{mA}$	V <sub>F</sub>	0.52	Volts
Maximum Average Reverse Current at $V_R = 10\text{V}$	I <sub>R</sub>	20	uAmps
Maximum Average Reverse Current at $V_R = 40\text{V}$	I <sub>R</sub>	90	uAmps

NOTES : 1. Measured at 1.0 MHz and applied reverse voltage of 0 volts.  
 2. ESD sensitive product handling required.

2014-05

## RATING CHARACTERISTIC CURVES ( CH521S-40GP )

### Typical Electrical Characteristics

